



Road Department

61150 SE 27th St. • Bend, Oregon 97702
(541) 388-6581 • FAX (541) 388-2719

ADDENDUM NO. 1

CONSTRUCTION OF THE POWELL BUTTE HIGHWAY ROUNDABOUT

The contract documents for the Construction of the Powell Butte Highway Roundabout are amended as follows:

INFORMATION TO BIDDERS:

1. Existing pavement thickness information:

Sample	Road	Station	Offset	AC Depth	Base Type	Comment
1	Neff RD		-10.5	6"	¾"	approx 500' west of PB Centerline
2	Neff RD		10	6"	¾"	approx 340' west of PB centerline
3	Alfalfa Mkt	88+16	9	5"	¾"	
4	Alfalfa Mkt	90+00	-10	5.75"	¾"	
5	Powell Butte	48+80	-9.4177	12"	Cinder/Sand	
6	Powell Butte	51+20	12	8"	Cinder/Sand	
7	Powell Butte	54+36	10.666	8"	Cinder/Sand	
8	Powell Butte	42+28	-7.5	8"	Cinder/Sand	
9	Powell Butte	40+50	7	7"	Cinder/Sand	
10	Powell Butte	39+66	-9	6.5"	Cinder/Sand	

- Excavation quantities noted in Special Provision Section 00330.81 include all existing materials. Existing pavement material quantities have not been removed from the total volumes.
- Contractor shall comply with Special Provision Section 0A596.31 – Manufacturer's Representative Qualifications and Duties
- A cleaner PDF version of Sheet L1.2 is attached for clarity on the earthwork required for the mounding shown by existing and proposed contours.

SPECIAL PROVISIONS:

- Delete Section 00640
- Add :Comply with Section 00641 of the Standard Specifications
- Add the following to Section 00759:
"00759.45 – Reinforcement, Dowels, and Tie Bars - Add the following: Fiber reinforcement shall be Fibermesh 300 or approved equal. Application rate shall be 1.5 lbs/CY or per manufacturer's recommendation."

4. Add the following special provision to Section 00990.70 Finishing and Testing:
“Manufacturer’s Representative – A Manufacturer’s representative is required to be present for the initial activation and calibration of the dynamic feedback warning sign. The Contractor shall contact the Manufacturer’s representative at least ten business days prior to the initial activation.”

BID SCHEDULE:

1. Delete page 53 and insert Page 53a (see attached). Changes the spec reference on bid items 170 and 180 from (00640) to (00641).

PLANS:

1. Sheet 22 (C7.0) – On the Construction Road Section 1/C7.0 delete the note starting with “Geotextile Fabric ...” and replace with “Geotextile Fabric, Tencate Mirafi HP 770 PET or approved equal (Sta 2+12 to 6+92)”. A new sheet is NOT being issued at this time.
2. Sheet L1.0 – Under Planting Notes 1 and 2, delete *Juniperus Occidentalis* and replace with *Pinus Ponderosa*. A new sheet is NOT being issued at this time.
3. Sheet 30 (IL1.0)
 - a. Additional detail has been provided for the foundation (FDN) legend note. See revised sheet in plan addendum.
 - b. The legend note for installation of un-metered service cabinets (SC/N) has been deleted. All service cabinets identified on the IL sheets have been removed and replaced with pedestals to be installed by Central Electric Cooperative. See revised sheet in plan addendum. *Note: The metered service called out on Sheet 41 (ES1.0) remains in the plan and will be provided and installed by the Contractor.*
 - c. The W legend note has been deleted. All conduit installed by Contractor to include a pull line. Central Electric Cooperative will pull all wiring.
 - d. A legend note for the pedestals (PED/N) has been added. See revised sheet in plan addendum. Detail referenced in note is included as an attachment to this addendum.
 - e. A legend note for the junction boxes to be installed per Sheet 41 (JB/EC) has been added. See revised sheet in plan addendum.
 - f. General Note 5 has been modified to indicate that Central Electric Cooperative will provide all pedestals identified in the plan. See revised sheet in plan addendum.
 - g. The Street Light Pole Schedule has been updated to show pedestal numbers rather than service numbers. See revised sheet in plan addendum.
4. Sheet 31 (IL2.0)
 - a. Plan has been updated to reflect changes to conduit layout requested by Central Electric Cooperative. All service cabinets identified on the IL sheets have been removed and replaced with pedestals to be installed by Central Electric Cooperative. All conduit for potential future dynamic warning signs will be installed through junction boxes. All conduit for the street lighting system will be laid and stubbed at locations shown for pedestal installation by Central Electrical Cooperative. Where possible, the same trench should be used for conduit associated with both systems. See revised sheet in plan addendum. *Note: The*

metered service called out on Sheet 41 (ES1.0) remains in the plan and will be provided and installed by the Contractor.

- b. The 6'x4'x4' vault previously shown in the plans has been deleted and replaced with a pedestal to be installed by Central Electric Cooperative. See revised sheet in plan addendum.

5. Sheet 32 (IL3.0)

- a. Plan has been updated to reflect changes to conduit layout requested by Central Electric Cooperative. All service cabinets identified on the IL sheets have been removed and replaced with pedestals to be installed by Central Electric Cooperative. All conduit for potential future dynamic warning signs will be installed through junction boxes. All conduit for the street lighting system will be laid and stubbed at locations shown for pedestal installation by Central Electrical Cooperative. Where possible, the same trench should be used for conduit associated with both systems.

6. Sheet 41 (ES1.0)

- a. The scale bar has been corrected. See revised sheet in plan addendum.
- b. The conduit layout has been updated to show the system as independent from the lighting system. See revised sheet in plan addendum.
- c. Additional detail has been provided for the metered service (MS) legend note. See revised sheet in plan addendum.
- d. The LP, SC/IL, and LC legend notes have been deleted as they are no longer referenced on this sheet.



George Kolb
Project Manager

1/14/16

Date

I acknowledge receipt of Addendum Number 1.

SIGNATURE OF BIDDER

Date

THIS SHEET, COMPLETE WITH ATTACHMENTS, TO BE SUBMITTED WITH BID PROPOSAL.

170	3/4 INCH - 0 AGGREGATE BASE (00641)	5,409	TON	\$ _____	\$ _____
180	AGGREGATE SHOULDERS (00641)	2,537	TON	\$ _____	\$ _____
190	LEVEL 3, 3/4 INCH ACP MIXTURE PG64-28ER (00744)	1,899	TON	\$ _____	\$ _____
200	LEVEL 3, 1/2 INCH ACP MIXTURE PG64-28ER (00744)	451	TON	\$ _____	\$ _____
210	LEVEL 3, 1/2 INCH ACP MIXTURE PG70-28ER (00744)	1,494	TON	\$ _____	\$ _____
220	CONCRETE CURBS, MOUNTABLE CURB, MODIFIED (00759)	5,384	FOOT	\$ _____	\$ _____
230	CONCRETE CURBS, INNER, MODIFIED (00759)	233	FOOT	\$ _____	\$ _____
240	PATTERNED CONCRETE SURFACING, 6 INCHES THICK (00759)	11,791	SQFT	\$ _____	\$ _____
250	PATTERNED CONCRETE SURFACING, 8 INCHES THICK (00759)	4,860	SQFT	\$ _____	\$ _____
260	CONCRETE SURFACING, BICYCLE EXIT RAMP (00759)	175	SQFT	\$ _____	\$ _____
270	CONCRETE SURFACING, CURB CUT (00759)	750	SQFT	\$ _____	\$ _____
280	GUARDRAIL, TYPE 1 (00810)	225	FOOT	\$ _____	\$ _____
290	GUARDRAIL END PIECES, TYPE B (00810)	2	EACH	\$ _____	\$ _____
300	TYPE 1-5W MODIFIED FENCE (01050)	140	FOOT	\$ _____	\$ _____
310	TYPE 2 FENCE (01050)	1,025	FOOT	\$ _____	\$ _____
320	TYPE 2 MODIFIED FENCE (01050)	645	FOOT	\$ _____	\$ _____
330	REMOVING AND REBUILDING FENCE (01050)	20	FOOT	\$ _____	\$ _____
340	MULTIPLE MAILBOX SUPPORTS (01070)	1	EACH	\$ _____	\$ _____

FILE: 0008917W-C-LP01 LAYOUT: L1.2 Landscape Grading Plan PATH: P:\Parametrix\0008917W\Design\Drawings\Civil\ PLOTTED BY: rinosaki DATE: Friday, November 13, 2015 9:01:40 AM

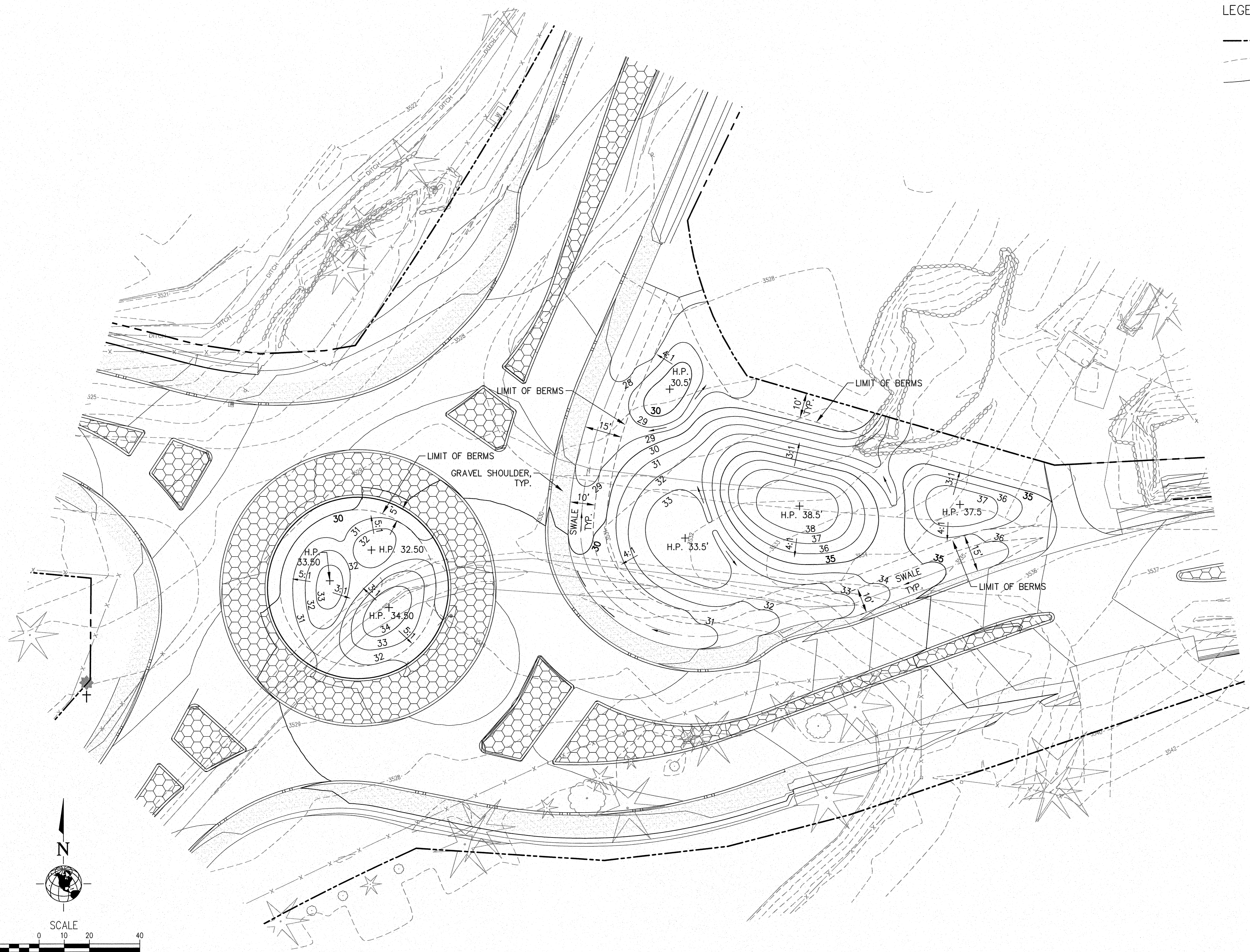
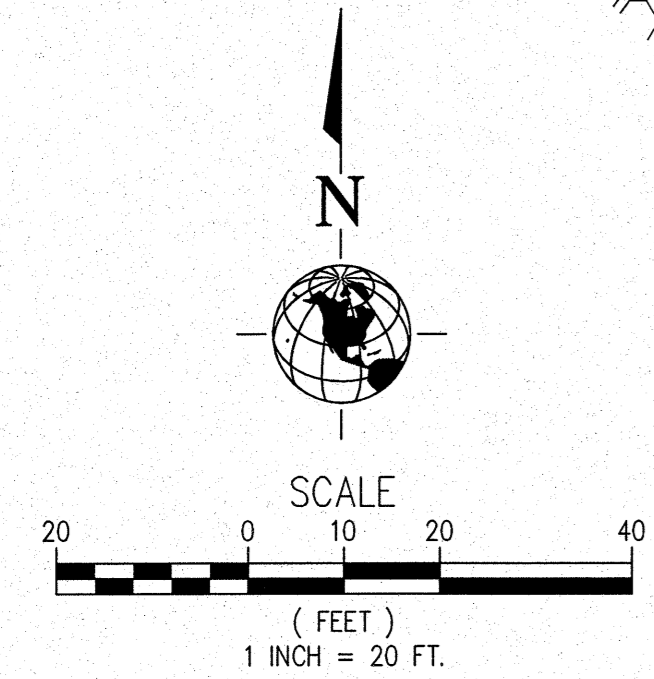

LEGEND

	RIGHT OF WAY
	EXISTING CONTOURS
	PROPOSED CONTOURS

REVISIONS	BY	DATE
Δ		

ONE INCH AT FULL SCALE. IF NOT SCALE ACCORDINGLY

Parametrix
ENGINEERING - PLANNING - ENVIRONMENTAL SCIENCES
565 SW BLUE DRIVE, SUITE B | BEND, OR 97702
P 541.508.7710
WWW.PARAMETRIX.COM

DATE: 2015	DESIGNED BY: RAI	CHECKED BY: MS
DATE: 2015	DRAWN BY: RAI	APPROVED BY: MS

REGISTERED
317
MICHAEL D. SMYTH
OREGON
LANDSCAPE ARCHITECT

PROJECT NAME
DESCHUTES COUNTY ROAD DEPARTMENT
POWELL BUTTE HIGHWAY ROUNDABOUT
DESCHUTES COUNTY, OR

LANDSCAPE
GRADING PLAN

DRAWING NO. OF
L1.2

ILLUMINATION LEGEND AND DETAILS
POWELL BUTTE HWY/NEFF RD/ALFALFA MARKET RD

STREET LIGHT POLE SCHEDULE

POLE NO.	PEDSTAL NO.	STREET	STATION	OFFSET*	LUMINAIRE ARM LENGTH	LAMP	LUMINAIRE MOUNTING HEIGHT (FT)	TYPE	NOTES**
1	5	Powell Butte	41+19	29.2' Rt	8'	LED	25'	III	Furnished and installed by CEC
2	5	Powell Butte	42+57	36.1' Rt	8'	LED	25'	III	Furnished and installed by CEC
3	5	Powell Butte	43+96	33.8' Rt	8'	LED	25'	III	Furnished and installed by CEC
4	9	Powell Butte	44+44	56.2' Lt	8'	LED	25'	III	Furnished and installed by CEC
5	4	Alfalfa Market	84+42	61.8' Rt	8'	LED	25'	III	Furnished and installed by CEC
6	3	Powell Butte	45+76	60.7' Rt	8'	LED	25'	III	Furnished and installed by CEC
7	6	Powell Butte	46+52	30.6' Lt	8'	LED	25'	III	Furnished and installed by CEC
8	7	Powell Butte	47+78	35.6' Lt	8'	LED	25'	III	Furnished and installed by CEC
9	8	Powell Butte	49+04	29.0' Lt	8'	LED	25'	III	Furnished and installed by CEC
10	8	Powell Butte	50+47	28.6' Lt	8'	LED	25'	III	Furnished and installed by CEC
11	8	Powell Butte	51+93	28.2' Lt	8'	LED	25'	III	Furnished and installed by CEC
12	10	Neff	25+96	24.9' Rt	8'	LED	25'	III	Furnished and installed by CEC
13	10	Neff	27+37	28.3' Rt	8'	LED	25'	III	Furnished and installed by CEC
14	9	Neff	28+77	29.3' Rt	8'	LED	25'	III	Furnished and installed by CEC
15	6	Neff	29+69	59.5' Lt	8'	LED	25'	III	Furnished and installed by CEC
16	3	Alfalfa Market	85+45	30.6' Lt	8'	LED	25'	III	Furnished and installed by CEC
17	4	Alfalfa Market	86+65	26.6' Rt	8'	LED	25'	III	Furnished and installed by CEC
18	3	Alfalfa Market	88+10	25.7' Lt	8'	LED	25'	III	Furnished and installed by CEC

* - Offset measured from roadway centerline.
** - Luminaire shall be Cree XSP1 Version C LED fixture model BXSP C HT 3ME E 40K-UL SV with backlight shield.

LIGHT LEVEL SUMMARY TABLE

ROADWAY/INTERSECTION	CLASSIFICATION	TARGET	LIGHT LEVEL	UNIFORMITY	LIGHT LOSS FACTOR	BUG RATING
Powell Butte Hwy at Alfalfa Mkt Rd/Neff Rd	Rural Arterial/ Rural Arterial	TARGET	≥ 0.9 fc	≤ 6 : 1	0.85	B1 UO G1
	DESIGN	0.9 fc	4.3 : 1			
Powell Butte Hwy - North Leg	Rural Arterial	TARGET	≥ 0.8 fc	≤ 6 : 1	0.85	B1 UO G1
	DESIGN	0.8 fc	4.0 : 1			
Powell Butte Hwy - South Leg	Rural Arterial	TARGET	≥ 0.8 fc	≤ 6 : 1	0.85	B1 UO G1
	DESIGN	0.8 fc	4.0 : 1			
Alfalfa Mkt Rd - East Leg	Rural Arterial	TARGET	≥ 0.8 fc	≤ 6 : 1	0.85	B1 UO G1
	DESIGN	0.8 fc	4.1 : 1			
Neff Rd - West Leg	Rural Arterial	TARGET	≥ 0.8 fc	≤ 6 : 1	0.85	B1 UO G1
	DESIGN	0.8 fc	4.2 : 1			

LEGEND

- (LP) Central Electric Cooperative to furnish and install new Central Electric Cooperative approved street light. Street light pole shall be HAPCO embedded aluminum alloy light pole (Model No. RTA25C7BEM18) and street light shall be Cree (Model: BXSP C HT 3ME E 40K-UL SV with backlight shield). See "Street Light Pole Schedule".
- (FDW) Install Central Electric Cooperative approved street light sleeve for embedded street light pole. See Central Electric Cooperative drawing number SR_210. Sleeve shall be 14" diameter PVC or galvanized steel. Use 3/4" gravel to level sleeve as necessary.
- (S) Install (S) inch electrical grade sch 40 pvc conduit.
- (EC) Electrical conduit, see Dynamic Feedback Warning Sign plan.
- (PL) Install poly pull line (500# minimum strength).
- (PS 2) Power source for 120/ 240 volt, single phase (field locate).
- (PED N) Electrical Service Pedestal N (N = Number), to be furnished and installed by C.E.C. Provide conduit sweeps to location shown, in accordance with C.E.C. New Pedestal Site Detail - Dated 04/24/2008.
- (MS EC) Metered service, see Dynamic Feedback Warning Sign plan.
- (JB 1A) Install 10"W X 17"L X 12"H precast junction box with concrete apron.
- (JB 2A) Install 12"W X 22"L X 12"H precast junction box with concrete apron.
- (JB EC) Junction Box, see Dynamic Feedback Warning Sign plan.
- (XX) Light pole number (XX), see "Street Light Pole Schedule".

GENERAL NOTES

1. All construction, workmanship, and materials shall be in accordance with Central Electric Cooperative electric service requirements.
2. Foundations, junction boxes, and conduit shall be installed at locations shown on plans. If conflicts arise, foundation, junction box, and conduit locations may be modified in the field per the engineer's approval. All lighting equipment must be placed within the right-of-way. Place conduit in same trench as other conduits whenever possible.
3. Location of existing utilities shall be verified. Coordinate all work with utility companies to eliminate conflicts.
4. All proposed street lighting junction boxes, conduits, pull ropes, and street light sleeves shall be installed by contractor per Central Electric Cooperative requirements.
5. All street light poles, luminaire arms, luminaires, lamps, pedestals, and wiring shall be furnished and installed by Central Electric Cooperative.
6. Final light pole locations shall be approved in the field by the engineer prior to foundation installation.
7. This illumination plans set is accompanied by Oregon Standard Drawing TM472.
8. All conduit elbows shall be factory made and be long radius 36". For conduit runs longer than 150' or containing more than 270 degrees of bends, elbows shall be fiberglass.
9. Contractor to coordinate with Central Electric Cooperative ten (10) business days in advance of commencing illumination work. Contact Tim Barrans at (541) 312-7721.
10. All conduit runs shall be approved by Central Electric Cooperative before backfill.
11. Cover and protect all new light pole sleeves.

REVISIONS	DATE	BY	NO.
	1/4/2016		

ONE INCH AT FULL SCALE NOT SCALE ACCORDINGLY

KITTELSON & ASSOCIATES, INC.
TRANSPORTATION ENGINEERING/PLANNING

DESIGNED: SWB
DRAWN: SWB
CHECKED: SGB
APPROVED: SGB

DATE: 11/25/2015
JOB NO.: 000581BW

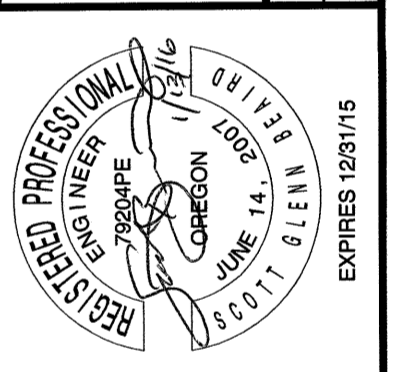

DESCHUTES COUNTY
ROAD DEPARTMENT
POWELL BUTTE HWY ROUNDABOUT
DESCHUTES COUNTY, OR

ILLUMINATION LEGEND
AND NOTES

ILLUMINATION PLAN
POWELL BUTTE HWY/NEFF RD/ALFALFA MARKET RD

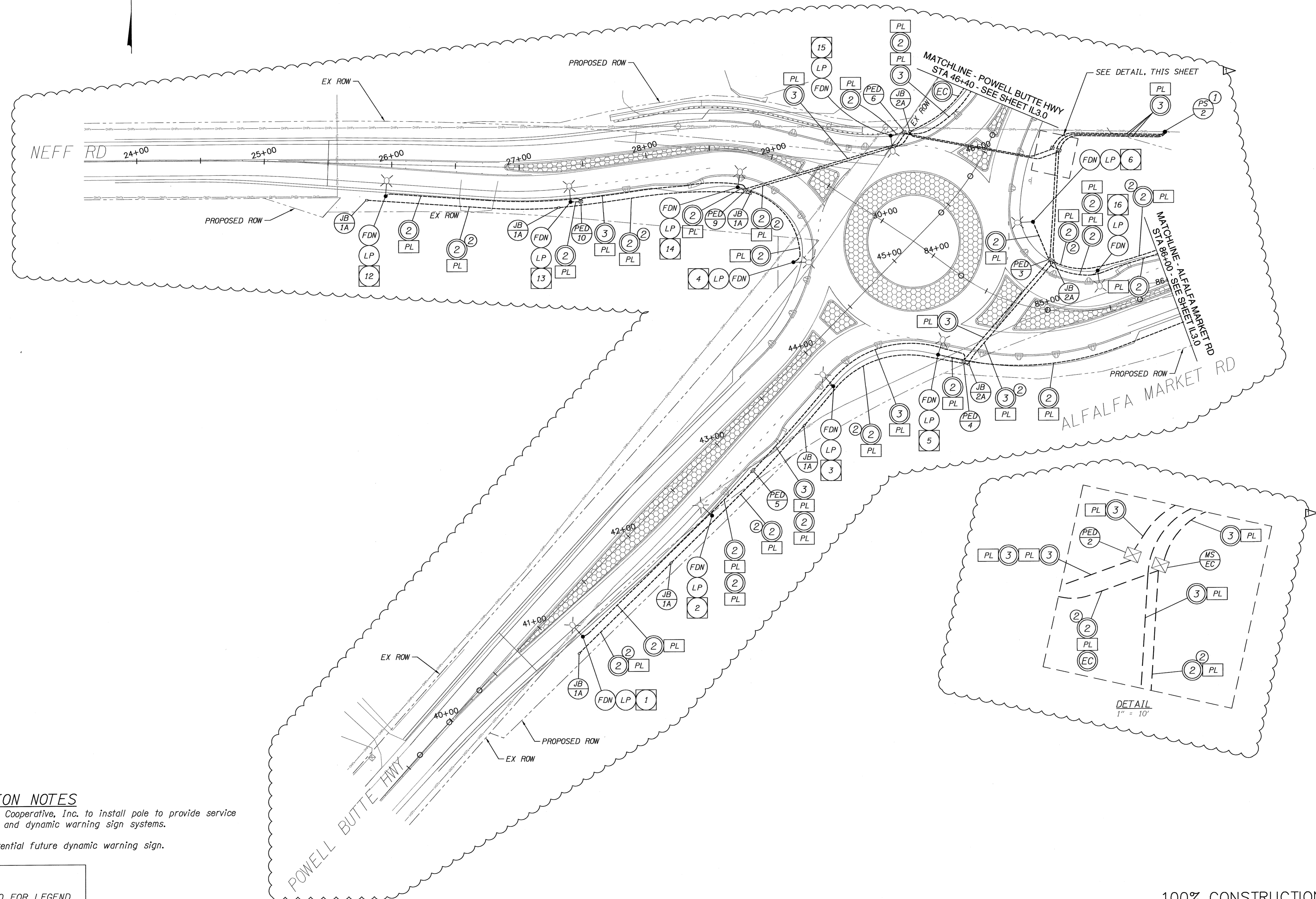
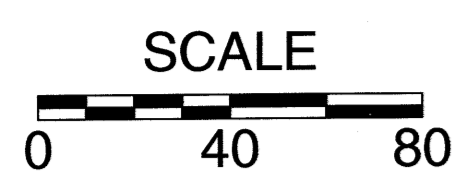

CONSTRUCTION NOTES

- ① Central Electric Cooperative, Inc. to install pole to provide service for illumination and dynamic warning sign systems.
- ② Conduit for potential future dynamic warning sign.

NOTE:
SEE SHEET IL.1.0 FOR LEGEND

BY:	SGB
DATE:	1/14/2016
REVISIONS:	ADDENDUM #1
▲	
▲	

ONE INCH SCALE. NOT TO SCALE ACCORDINGLY

KITTELSON & ASSOCIATES, INC.
TRANSPORTATION ENGINEERING/PLANNING

DESIGNED: SWB
DRAWN: SWB
CHECKED: SGB
APPROVED: SGB

DATE: 11/25/2015
JOB NO.: 0005818W

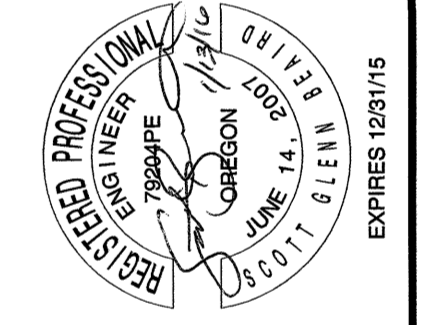

DESCHUTES COUNTY
ROAD DEPARTMENT
POWELL BUTTE HWY ROUNDABOUT
DESCHUTES COUNTY, OR

ILLUMINATION PLAN

ILLUMINATION PLAN
 POWELL BUTTE HWY/NEFF RD/ALFALFA MARKET RD

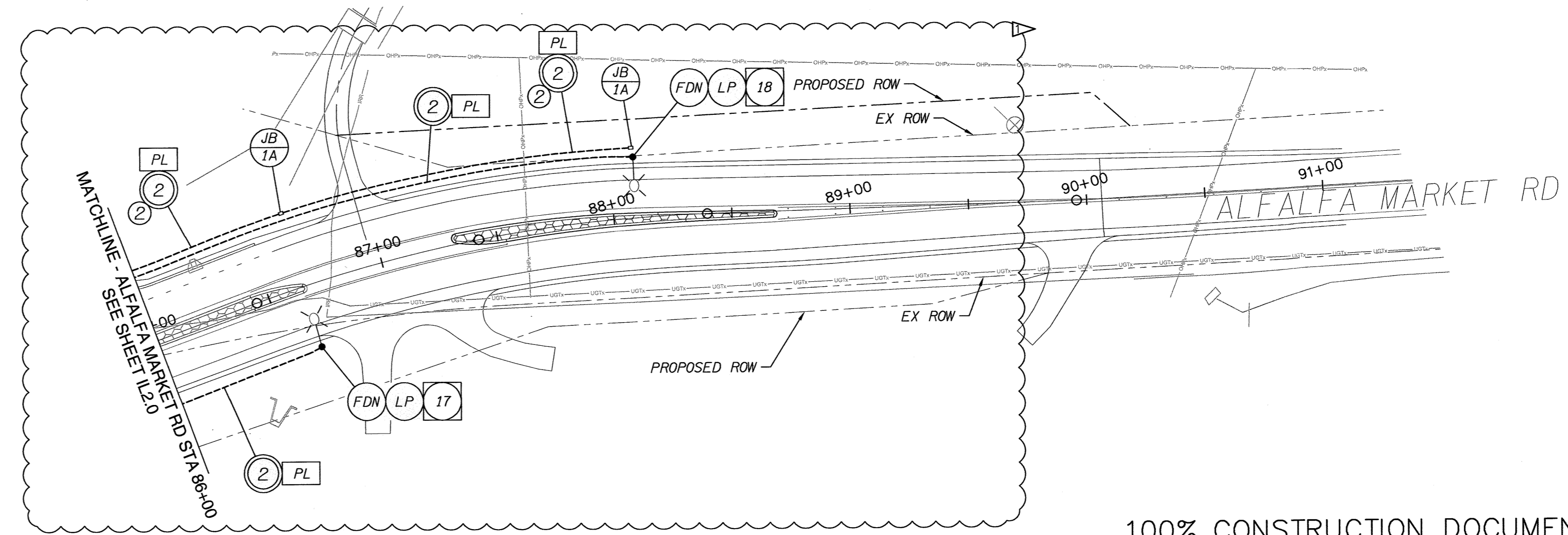
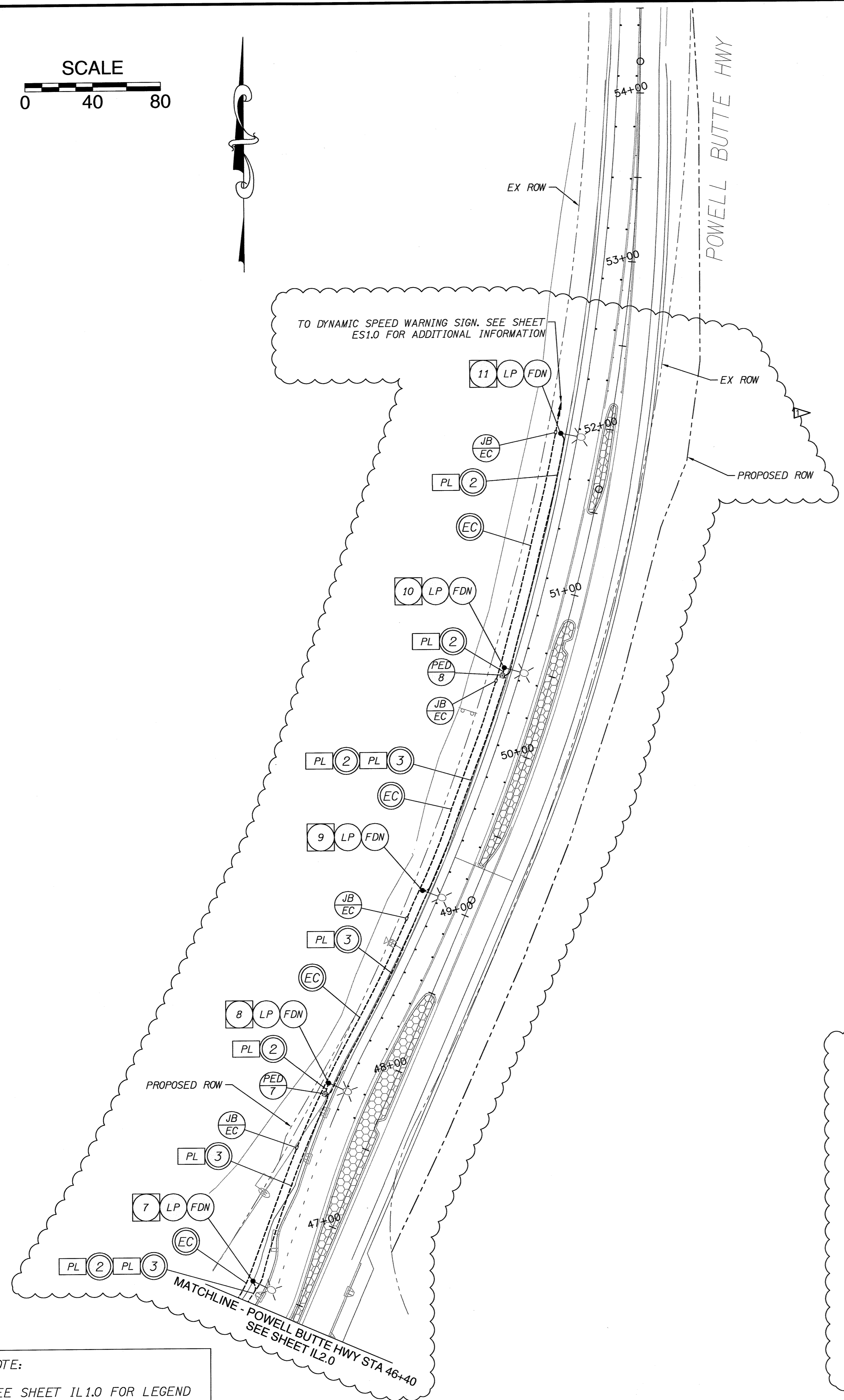
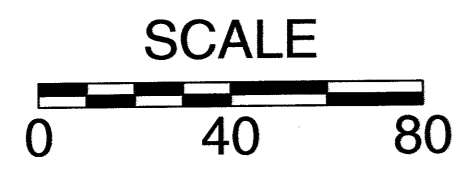

NOTE:
 SEE SHEET IL1.0 FOR LEGEND

REVISIONS	BY	DATE
Δ	SGB	1/14/2016
Δ		
	ADDENDUM #1	

ONE INCH
 AT FULL
 SCALE
 NOT SCALE
 ACCORDINGLY

KITTELSON & ASSOCIATES, INC.
 TRANSPORTATION ENGINEERING/PLANNING

DESIGNED: SWB
 DRAWN: SWB
 CHECKED: SGB
 APPROVED: SGB

DATE: 11/25/2015
 JOB NO.: 000581BW

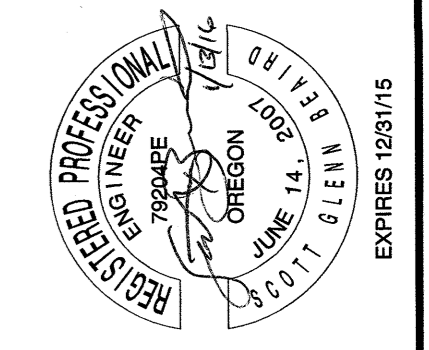

DESCHUTES COUNTY
 ROAD DEPARTMENT
 POWELL BUTTE HWY ROUNDABOUT
 DESCHUTES COUNTY, OR

ILLUMINATION PLAN

GENERAL NOTES

1. All materials and workmanship shall conform to the requirements and specifications of the Manual on Uniform Traffic Control Devices (M.U.T.C.D.) latest edition, the Oregon supplement to the M.U.T.C.D., the Oregon Standard Specifications for Construction, Deschutes County construction standards, and the project special provisions.
2. Detail indicates general design only in so far as equipment is concerned. It is not to be construed as being an exact representation in as much as details of design will vary among different manufacturers. Do not scale drawing.
3. All bolts, nuts, and washers shall be stainless steel unless noted otherwise. All set screws shall be min. dia. 1/4" stainless steel with square or hex heads.
4. The W2-6 element of the display will be supplemented by "SLOW DOWN" warning in text height 6", and will be further visually enhanced by the employment of 4-5" diameter flashing amber beacons in each corner of the main display. Beacons will flash in horizontal pairs in accordance with the MUTCD flash rate.
5. Coordinate programming with engineer to determine trigger speed for sign activation.

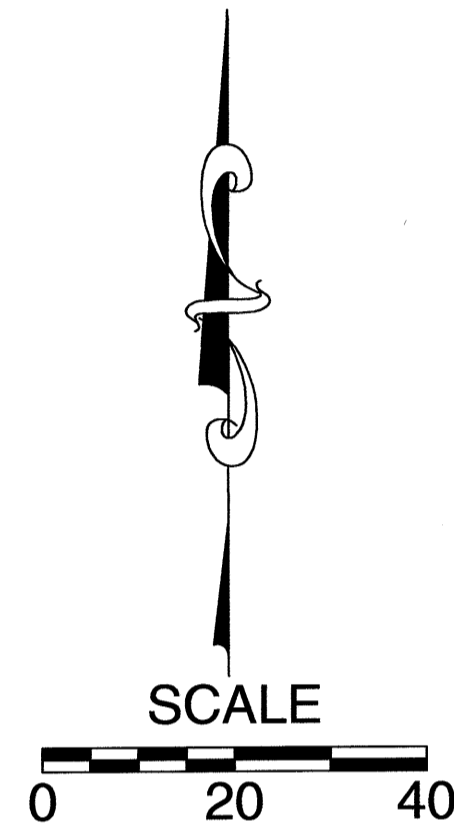

SCALE
0 20 40

**DYNAMIC FEEDBACK WARNING SIGN PLAN
POWELL BUTTE HWY/NEFF RD/ALFALFA MARKET RD**

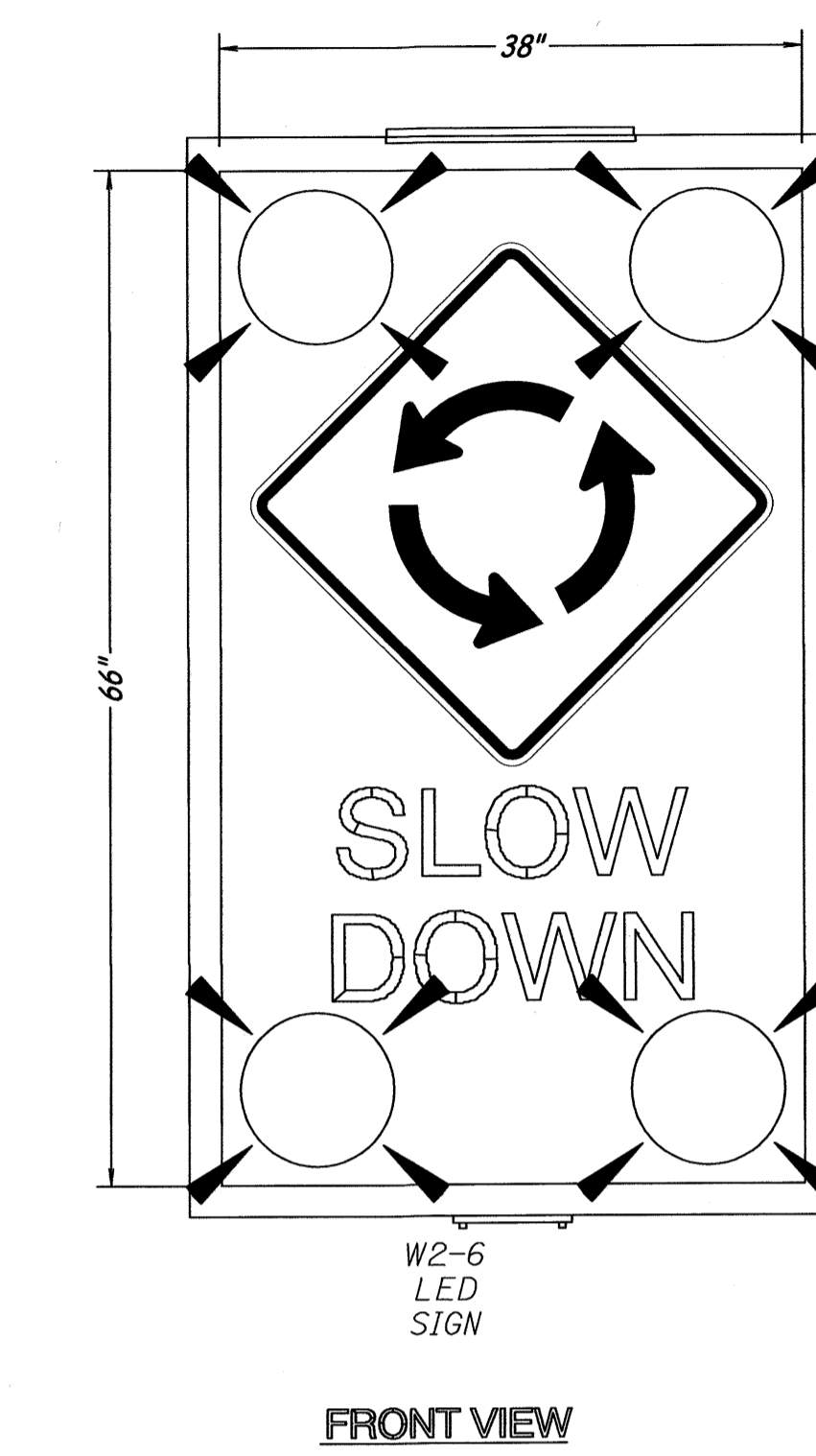
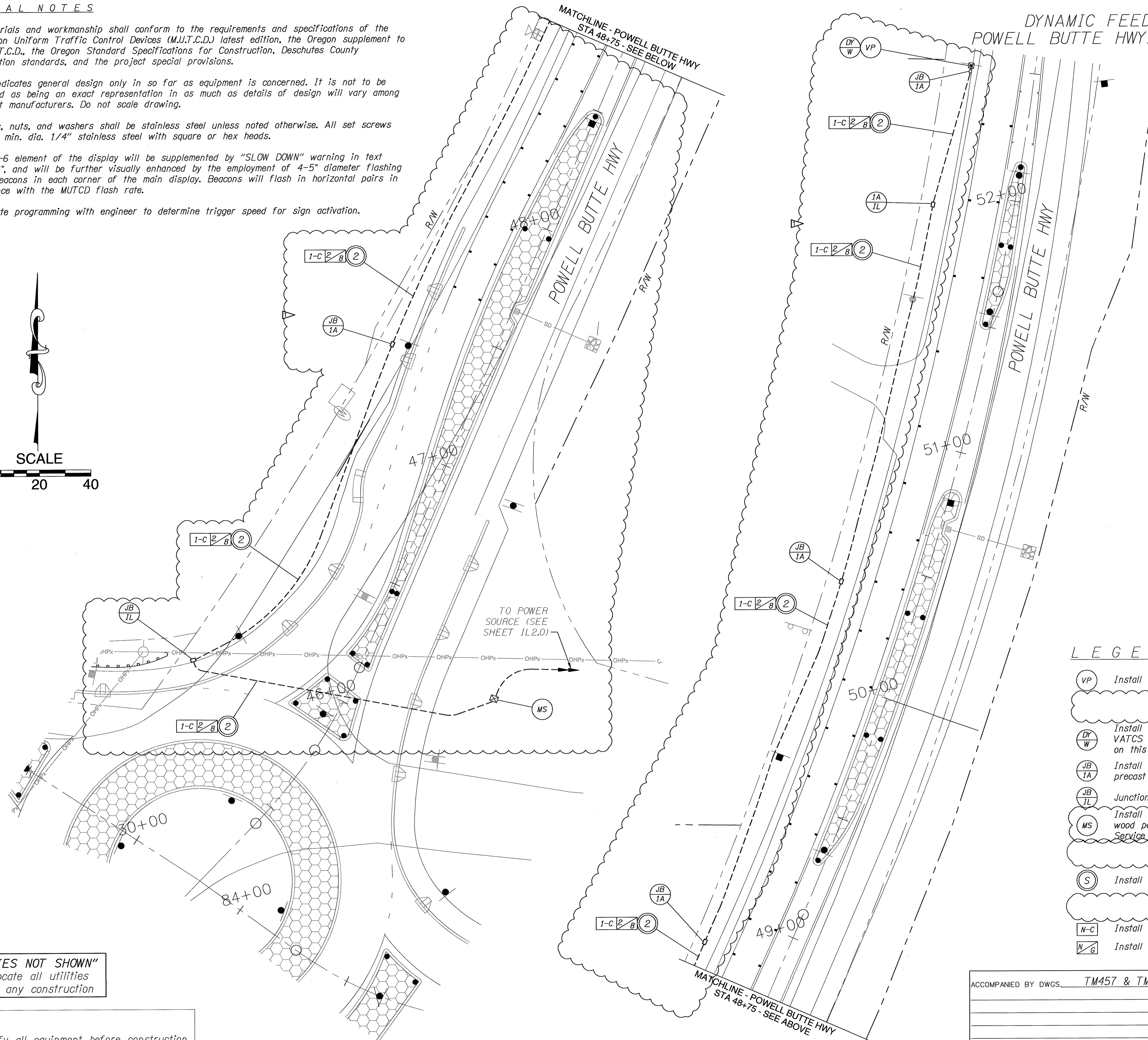

LEGEND

- (VP) Install vehicle signal pedestal with transformer base
- (DR/W) Install (38"x66") "ROUNDAHEAD" Unipart Dorman VATCS dynamic feedback sign, or approved equal, see details on this sheet. See Special Provisions for additional information.
- (JB/IA) Install 17"x10"x12" (min. dimension) precast concrete junction box with concrete apron
- (JB/IL) Junction box (See Illumination Plan)
- (MS) Install 120/240 volt, single phase metered service on a 4"x4" wood post per direction from Central Electric Cooperative. Service shall include a manual bypass.
- (S) Install (S-size) inch electrical grade sch 40 pvc conduit.
- (N-C) Install (N=number) No. 8 AWG THWN (Signal system common)
- (N-G) Install (N=number) No. (G=AWG wire size) THWN wires

"UTILITIES NOT SHOWN"
Field locate all utilities prior to any construction

NOTE:
Field verify all equipment before construction.

ACCOMPANIED BY DWGS. TM457 & TM472

BY	SOB
DATE	1/14/2016
REVISIONS	ADDENDUM #1
Δ	

ONE INCH AT FULL SCALE NOT SCALE ACCORDINGLY

KITTELSON & ASSOCIATES, INC.
TRANSPORTATION ENGINEERING/PLANNING

CHECKED: SCB
DESIGNED: SCB
DRAWN: RAM
APPROVED: RAM

DATE: 11/30/2015
JOB NO.: 000581BW

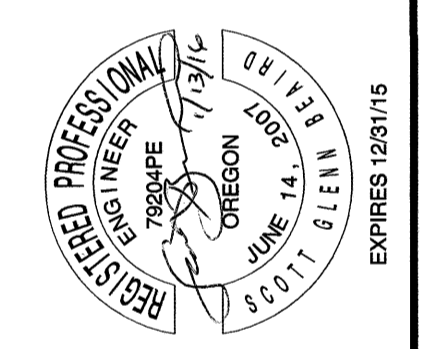

DESCHUTES COUNTY
ROAD DEPARTMENT
POWELL BUTTE HWY ROUNDAHEAD
DESCHUTES COUNTY, OR

DYNAMIC FEEDBACK
WARNING SIGN PLAN

TRIM CONDUIT TO 6"
BELOW CURB LEVEL
(FINISH GRADE LEVEL)

2'
CLEAR ZONE
AROUND
PEDESTAL

OTHER
UTILITY

1.5 FT RADIUS
AROUND CONDUIT

12"

6"

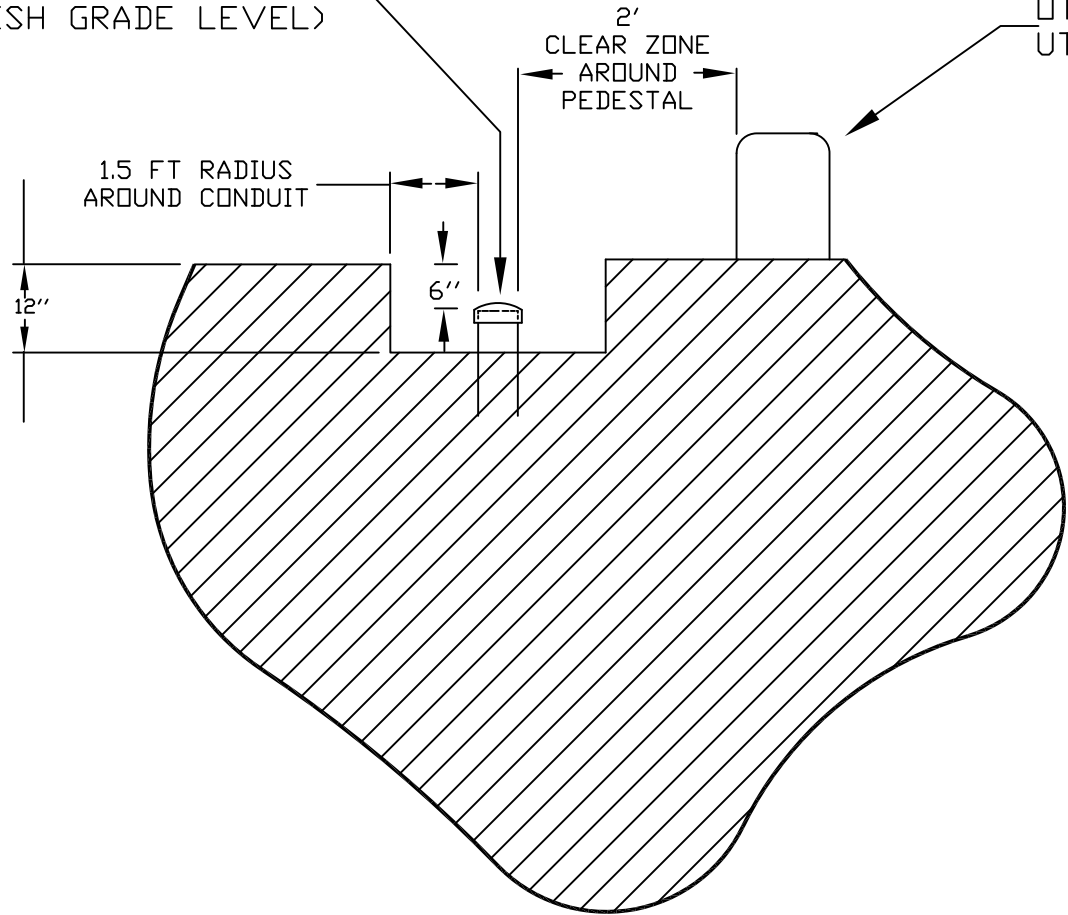

CENTRAL ELECTRIC
COOPERATIVE, INC.

NEW PEDESTAL SITE DETAIL

Date: 04/24/2008